

DESCRIPTION

LOT 1, BLOCK 927, PORT MALABAR UNIT EIGHTEEN ACCORDING TO THE PLAT THEREOF AS RECORDED IN PLAT BOOK 15, PAGES 109 THRU 119 OF THE PUBLIC RECORDS OF BREVARD COUNTY, FLORIDA.

- NOTES:
- 1.) BEARINGS BASED ON THE ASSUMPTION THAT THE CENTERLINE OF WANETA STREET SE BEARS N89°25'27"W PER PLAT OF PORT MALABAR UNIT EIGHTEEN.
 - 2.) LOT DIMENSIONS ARE AS PLATTED(P) AND SURVEYED(S) UNLESS OTHERWISE NOTED.
 - 3.) PROPERTY LIES WITHIN SECTION 16, TOWNSHIP 29 SOUTH, RANGE 37 EAST.
 - 4.) PU & DE DENOTES PUBLIC UTILITIES AND DRAINAGE FACILITIES EASEMENT.
 - 5.) ELEVATIONS "EL=34.38" BASED ON NATIONAL GEODETIC VERTICAL DATUM OF 1929.
 - 6.) PARENT BENCHMARK, CITY OF PALM BAY BM 18-271, MAG NAIL C/L TOP OF WEST ENDWALL DRIVEWAY OVER PIPE (L-2, B-927) #1610 WANETA STREET, EL=35.243, NATIONAL GEODETIC VERTICAL DATUM OF 1929.
 - 7.) NO ID DENOTES NO IDENTIFICATION.

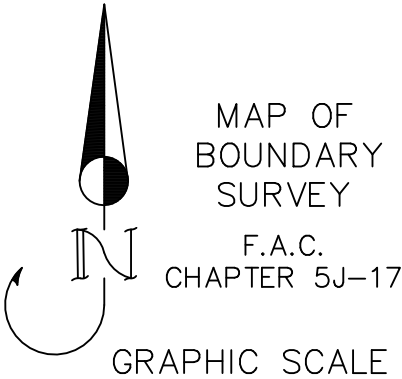

WJS WILLIAM J. SUITER
LAND
SURVEYING, INC.

1849 CANOVA STREET S.E.
PALM BAY, FLORIDA 32909
BILL@WJSUITER.COM
WJSUITER.COM
(321) 728-0553

REVISIONS

WHEN PRINTED THIS DOCUMENT IS NOT CONSIDERED SIGNED AND SEALED. THIS SURVEY IS ONLY VALID WHEN THE SIGNATURE CAN BE VERIFIED ON THE ELECTRONIC DOCUMENTS ONLY. THIS DOCUMENT HAS BEEN DIGITALLY SIGNED AND SEALED.

William J Suiter
Digitally signed by William J Suiter
Date: 2024.03.13 15:02:07 -04'00'

PROFESSIONAL SURVEYOR AND MAPPER IN RESPONSIBLE CHARGE
WILLIAM J. SUITER
FLORIDA CERTIFICATE NO. 4210
CERTIFICATE OF AUTHORIZATION #LB 5419

COPYRIGHT © 2024 WILLIAM J. SUITER LAND SURVEYING, INC. ALL RIGHTS RESERVED

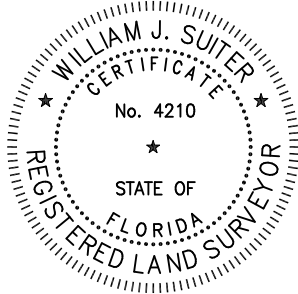

FLOOD ZONE X FLOOD INSURANCE RATE MAP NUMBER 12009C0660G.

SURVEY DATE: MARCH 7, 2024

SCALE: 1" = 20'

FIELD BOOK: N/A

PAGE: N/A

JOB NUMBER: 24-34